

Sapheno Femoral Junction (SFJ) Ligation Technique Trainer User Guide

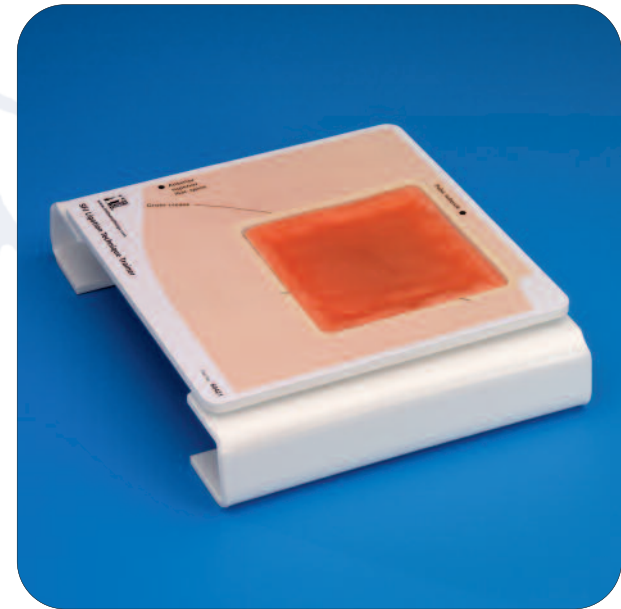

Designed and manufactured by Limbs & Things Limited,
Sussex Street, St. Philips, Bristol, BS2 0RA, UK.
Telephone: +44 (0)117 311 0500 Fax: +44 (0)117 311 0501
sales@limbsandthings.com www.limbsandthings.com

Issue 2, August 2007
© 2005 Limbs & Things

For more skills training products visit

www.limbsandthings.com

Sapheno Femoral Junction (SFJ) Ligation Technique Trainer

Part No: **60421**

A realistic representation of the right groin region for training in the skills needed to ligate the sapheno femoral junction.

Used as part of the European Board of Vascular Surgery (EBVS) exam.

Skills

- Incision
- Tissue plane dissection
- Ligation of venous tributaries and junction

Features

- The SFJ Ligation Block presents the following realistic anatomy: skin, fat, fascia lata, femoral vein and its junction onto the saphenous vein
- The fat is accurately layered and separates extremely realistically through blunt dissection
- Veins are filled with mock blood
- Luer lock allows for connection to Mock Blood Giving Set. Only use **Mock Blood - Venous** Part No: **00223**
- Blocks are quick and easy to replace during training courses
- Clamps provided to secure Trainer to edge of bench top

Package supplied

- 1 **SFJ Ligation Block (Pack of 2)** Part No: **60420**
- 1 **SFJ Ligation Location Plate** Part No: **60424**
- 1 **Procedure Base** Part No: **60425**
- 2 bench top clamps

Setting up the Procedure Base

1

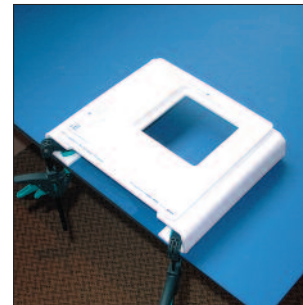
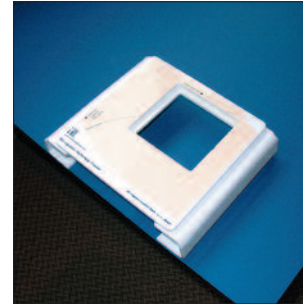

Position the Base at the edge of the bench top. Ensure that the base is in the correct anatomical orientation.

Clamp the base to the edge of the bench top.

2

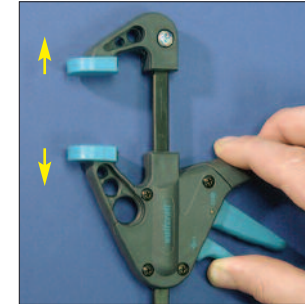

To open the clamp squeeze and hold the small lower lever.

The jaws will move freely until the lever is released.

3

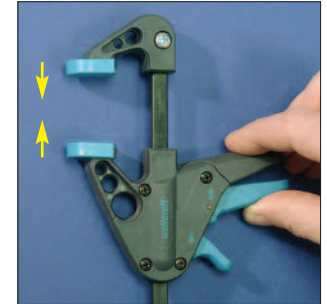

To close the jaws squeeze the large upper lever.

Each time the lever is squeezed the jaws move closer together.

Health & Safety

- The SFJ Blocks contain latex; persons allergic to latex should wear latex free surgical gloves when using this product.

Inserting the SFJ Block

1

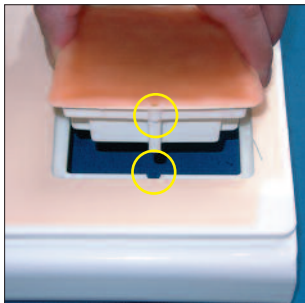

Ensure the correct orientation of the Block by lining up the locator bump with the corresponding notch in the base.

The side of the Block with the vessel and luer lock should be inserted first. The Limbs & Things Mock Blood Giving Set can be connected to the luer lock.

2

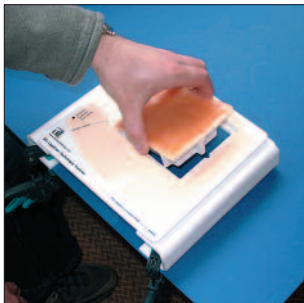

Insert the SFJ Block into the aperture.

Press the Block into place in the corners...

3

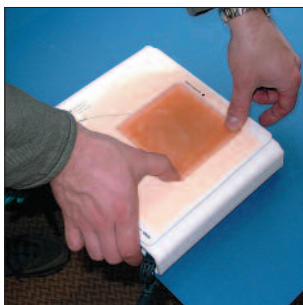
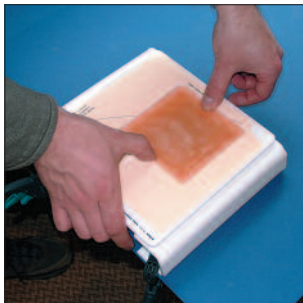

...the middle...

... and the other corners. The Velcro® should engage with a firm action when the Block is secured.

The SFJ Trainer is now ready to use. For extra realism the Trainer can be correctly draped so that it appears to be the skin of a real patient.

Removing the SFJ Block

1

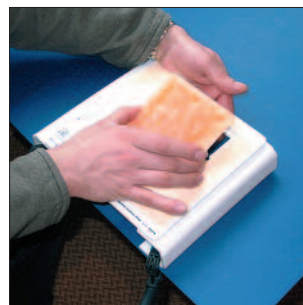
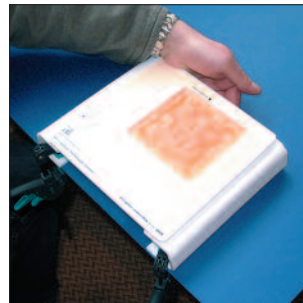

With the Base still clamped to the bench top, place your hand under the Block and push upwards firmly.

The Block should pop up out of the aperture and can then be removed.

Removing the SFJ Ligation Location Plate

1



With the Base still clamped to the bench top, hold the Location Plate by the edge.

Lift the Plate. The curved cut out in the Base allows for easy handling of the plate and its removal.

4

Attaching the Location Plate

1

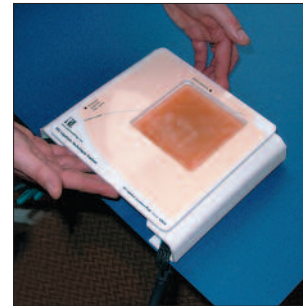
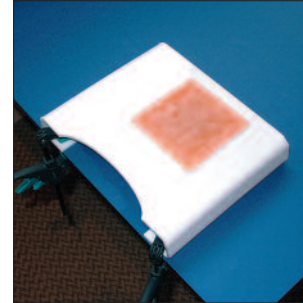

For quick and easy alignment of the Plate make sure an SFJ Block has been inserted into the Base. (Instructions for this can be found on page 2).

Position the Plate over the Base and line up the aperture with the SFJ Block. Ensure that the Plate is in the correct anatomical orientation.

2

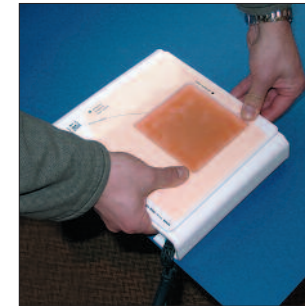
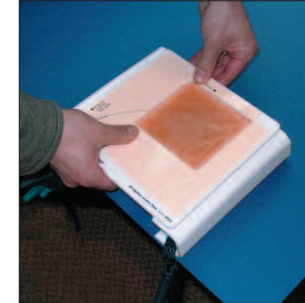

Rest the Plate on top of the Base and press down on the corners of the aperture.

The Velcro® should engage with a firm action when the Plate is secured.

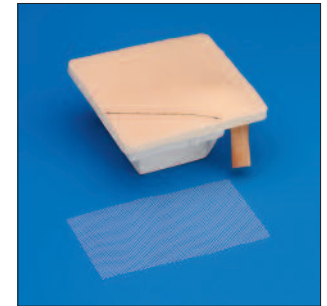

The SFJ Trainer shares the same product design as the Open Inguinal Hernia Repair Trainer: Procedure Base, Location Plate and Block.

To this end the Hernia Location Plate and the Hernia Block (shown above) can be purchased separately and used in conjunction with the existing Procedure Base.

5